



PV 350



The PV350 is a 37 m long fast boat in GRP that can be used as a coastal and offshore patrol boat, for police and rescue operations. It is highly customisable in terms of propulsion and interior layout and features.

OUTLINE SPECIFICATION

Hull type	Planning, Twin Waterjet Fast Patrol
Builder	Baglietto S.p.A.
Hull and engineering	Baglietto S.p.A.

MAIN DATA

Length over all	37,47 m 122 ft 8 in
Length at waterline	30,95 m 101 ft 6 in
Beam	7,20 m 23 ft 7 in
Draft	1,35 m 4 ft 5 in
Depth	4,70 m 15 ft 5 in
Full load displacement	156 t 343,920 lb
Fuel capacity	31.240 lt 8,252 US gal
Fresh water capacity	2.250 lt 594 US gal
Crew capacity	17+2
Material of hull	Aluminium
Propulsion	2 x Waterjet
Main engine	2 x MTU 16V 4000 M93L
Maximum power	2 x 3.440 kW (4.613 hp) at 2.100 rpm
Maximum speed	36 kn
Cruising speed	28 kn
Range at cruising speed	700 nm

ALTERNATIVE OPTION

Propulsion	2 x Shaft line (V-drive)
Main engine	2 x MTU 16V 4000 M93L
Maximum power	2 x 3.440 kW (4.613 hp) at 2.100 rpm
Maximum speed	32 kn

- It can be fitted with either surface drives or water jets, resulting in a maximum half load speed of 36 kn. Both types of propulsion allow to cruise in shallow waters.
- It can carry up to 19 crew members and remain at sea for 10 days, also thanks to particularly carefully-designed interiors ensuring the utmost comfort.
- Two tenders with dedicated davits are located on the deck.
- The deep-V bottom has been extensively tested and ensures excellent speed and seakeeping performance.
- In patrolling conditions at 28 kn its operating range is 700 nm.
- The superstructure features modern stealth shapes, typical of patrol boats.

PV 350

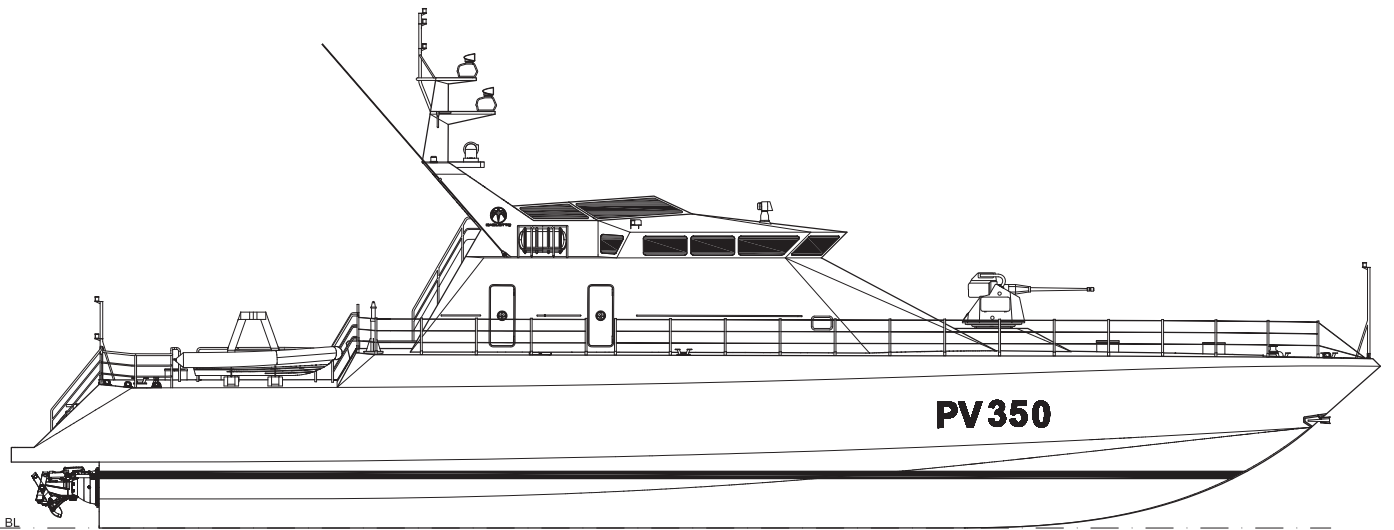

Longitudinal sect.

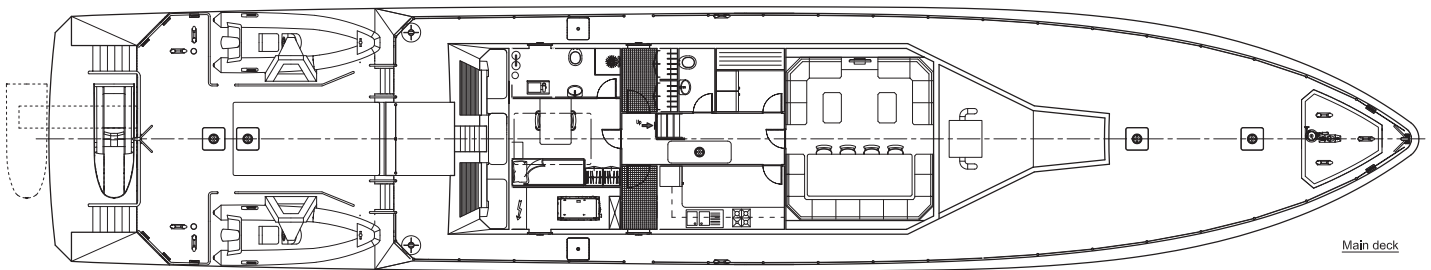

Main deck

-5 -4 -3 -2 -1 0 1 2 3 4 5 6 7 8 9 10 11 12 13 14 15 16 17 18 19 20 21 22 23 24 25 26 27 28 29 30 31 32 33 34 35 36 37 38 39 40 41 42 43 44 45 46 47 48 49 50 51 52 53 54 55 56 57 58 59 60 61 62 63 64 65 66 67 68 69 70

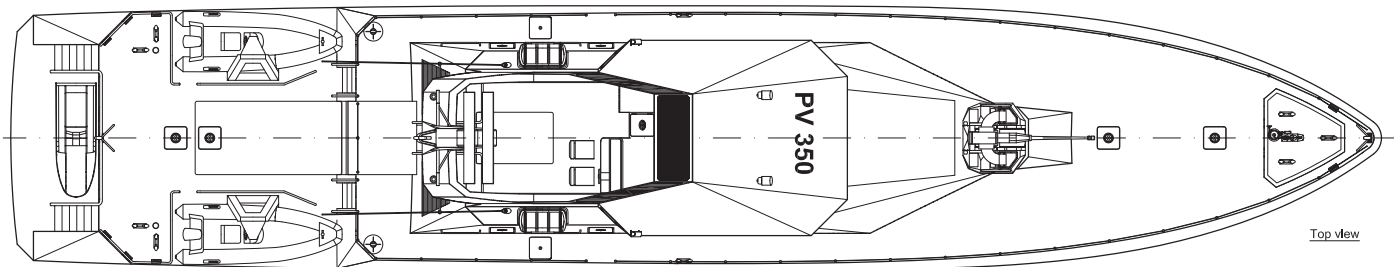

Top view

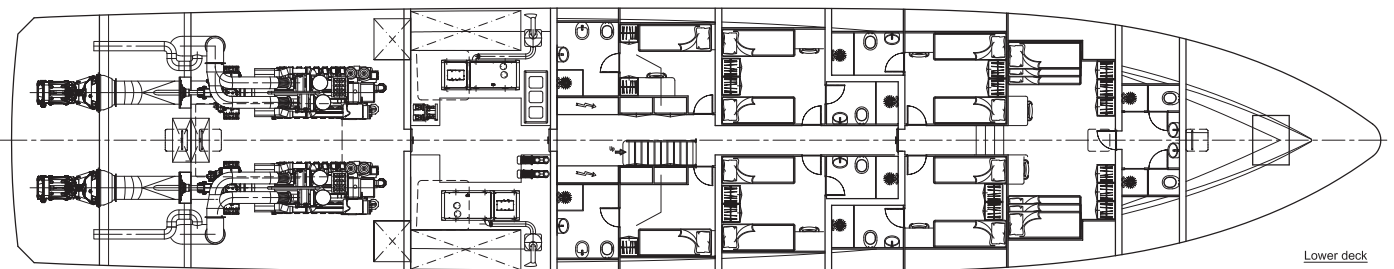

Lower deck

-5 -4 -3 -2 -1 0 1 2 3 4 5 6 7 8 9 10 11 12 13 14 15 16 17 18 19 20 21 22 23 24 25 26 27 28 29 30 31 32 33 34 35 36 37 38 39 40 41 42 43 44 45 46 47 48 49 50 51 52 53 54 55 56 57 58 59 60 61 62 63 64 65 66 67 68 69 70

